

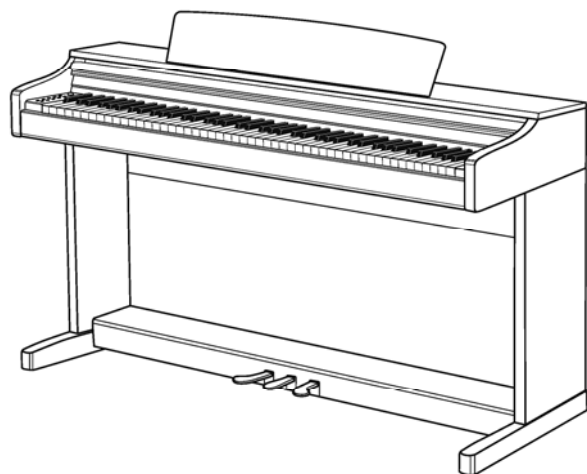

# OWNER'S MANUAL

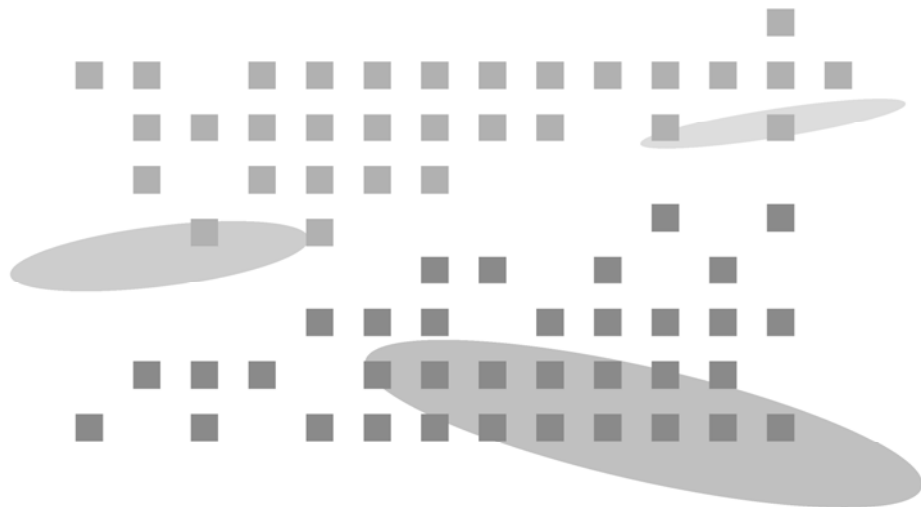

*USB Stereo Digital Piano*

**Before reading:****Safety Instructions**

This section is intended to keep the user safe and prevent financial loss.  
Please read this section carefully and use the product properly according to it.

**WARNING:**

Not observing this warning could result in death or serious injury for the user.

**CAUTION:**

Not observing this caution could result in injury and/or financial loss for the user.

**WARNING:**

**To avoid the possibility of death or physical injury due to electric shock, short circuit, damage or fire, please observe the fundamental safety instructions listed below.**  
**This warning includes the following:**

- Never open the product or attempt to break down or modify the inner parts. This product has no user-serviceable components. If you believe the product is malfunctioning, please immediately cease the use of the product and contact customer service for repair.
- Do not expose the product to rain. Do not use the product under watery or wet environment, and avoid placing liquid containers on the product as it may spill into the product. If any liquid is spilled into the product, immediately turn off the product, take the plug off the AC outlet and contact customer service for inspection.
- If the power cord or plug is wore off or damaged, or the product suddenly stops sounding, or any unknown smell or smoke is detected emerging from the product, immediately turn off the product, take the adapter plug off the AC outlet and contact customer service for inspection.
- Only use voltages that are designated for this product. The designated voltages are printed on the nameplate of the product.
- Always take the plug off the outlet prior to cleaning the product. Never insert or take off the plugs with wet hands.
- Regularly check the condition of the power plug, and remove any substances or dust that may have accumulated on it.

**CAUTION**

**To avoid the possibility of physical injury, damage of this product or other financial loss, please observe the fundamental safety instructions listed below. This caution includes the following:**

- Do not place the power cord nearby heat generators like heaters or radiators. Bending the cord too much could damage the cord. Do not put heavy objects on the cord, or leave the cord on a location where others could step on or trip over it.
- When removing the plug from the product or outlet, always seize the neck of the plug. Seizing and pulling the cord could damage it.
- Do not use multi-connectors to power the product. Doing so could result in lowered sound quality and/or overheating of the outlet.
- When not using the product for an extended period of time, or during an electric storm, take the plug off the outlet.
- When connecting the product to another electric product, turn off the powers of both products before connecting. Set the volumes of all products to minimum before turning on or off the products. After making sure that all volumes are set to minimum, begin using this product and gradually increase the volume until the desired level is reached.
- Do not expose this product to excessive dust, vibration, or locations/sources of extreme heat (direct sunlight, nearby heaters, inside cars during daytime). Exposure to such environments may result in external and/or internal damage.
- Do not use this product nearby TV, radio, stereo sound device, mobile phones or other electric devices. Doing so could result in excessive noise from either this product or the TV/radio.
- Do not place the product on unstable locations where it could fall off.
- Always remove all cables from the product before moving it.
- When cleaning the instrument, use soft and dry or lightly wet cloth. Do not use cleansing cloth imbued with paint diluent, solvent, cleansing agent or chemical substances. Also do not place any objects made of vinyl, plastic or rubber on the product. Doing so could result in color alteration of the panel or the keyboard.
- Do not place your weight or heavy objects onto the product.
- Do not use excessive force while manipulating the buttons, switches or connectors.
- Be careful not to leave fingers inside the key cover. Do not insert fingers inside the key cover or any other gap between the parts of this product.
- Do not insert or drop any objects like paper or metal substances on the key cover, panel, or in the gap between keys. When done so accidentally, immediately turn off the power of the product, take the plug off the outlet, and contact customer service.
- Maintain 3 inches of space between the piano and the wall or other nearby objects. Insufficient space could interfere with air circulation and may result in overheat.
- Carefully read the guide on assembling process and follow the steps provided. Not doing so could result in damage of the instrument and/or injury for the user.
- Avoid using the product on volume high enough to be disturbing to ears for extended period of time, as doing so could affect one's hearing permanently. If you experience hearing difficulty, or ringing on the ears, contact a physician.
- During thunderstorms, take the plug off the outlet.

Product Features

Thank you for choosing this product.

This digital piano is an advanced instrument capable of reproducing natural and beautiful piano sound along with many other quality instrument sounds so that it may match the diversity of the musical genres today and express the delicate expressions of the player to the fullest details. Also included are the features to record and replay what is played on the instrument, and USB MIDI jacks to allow for easy connections with PC without the need for any external MIDI devices.

To take full advantage of the wide range of features and capabilities offered by this instrument, please read this user's manual carefully.

Please keep this manual along with the quality certification.

Thank you.

Table of Contents

<b>Before Reading:</b>	<b>1</b>	<b>Functions</b>	<b>24</b>
Safety Cautions	1	Transpose	24
Product Features	3	Tune	24
		Touch	25
<b>Table of Contents</b>	<b>4</b>		
<b>Product Components</b>	<b>5</b>	<b>MIDI</b>	<b>25</b>
		MIDI Local Control	25
<b>Assembling the Product</b>	<b>6</b>	<b>MIDI Implementation Chart</b>	<b>26</b>
<b>Parts</b>	<b>8</b>	<b>GM Voice &amp; Drum Table</b>	<b>27</b>
Power Switch	8	GM Voices	27
Headphone Jacks	8	Drum Table	28
Connecting with External Devices	9		
Pedals	10	<b>Troubleshooting</b>	<b>39</b>
Control Panel	11		
Voice KEYMAP	11	<b>Product Specifications</b>	<b>30</b>
Function KEYMAP	12		
<b>Basic Control</b>	<b>13</b>		
Adjusting Volumes	13		
Choosing Voice	13		
Layer	14		
Split	15		
EXV (Expanded Voice)	16		
Twin Piano	17		
Default All	17		
Reverb	17		
<b>Metronome</b>	<b>18</b>		
Turning On/Off	18		
Adjusting Tempo	18		
Setting Beats	18		
<b>Record</b>	<b>19</b>		
Record & Play	19		
<b>Demo/Education Music</b>	<b>20</b>		
Choosing and playing a demo work	20		
Adjusting the volume of demo performance	20		
Selected Works by composer	21		
Beyer/Czerny Etude Series	22		
Burgmuller 25 Etudes/Sonatines	23		

## Product Components

After purchasing the product, carefully unpack it and examine the existence and condition of the items listed below. If an item is missing or damaged, contact the store where it was purchased.

Piano Main Body

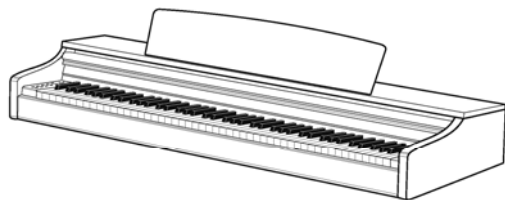

Left/Right Legs (a, b)

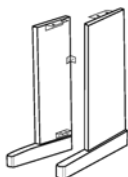

Pedal Plate (c)

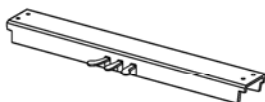

Backplate (d)

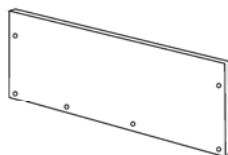
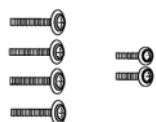
Pedal Plate Fixers  
(e) (M6 × 25)mm, 4EABackplate Fixers  
(f) (M4 × 22)mm, 4EA  
(g) (M4 × 8)mm, 2EAMain Body Fixers  
(h) (M6 × 15)mm, 2EA

AC Adapter



→ Keeping the original packing materials can be very useful in the event where you need to re-pack the product in order to move it to a faraway location.

## Assembling the Product

### 1 Assembling the legs and pedals

① Place the **pedal plate (c)** between the **legs (a, b)** like the picture below and use the **pedal plate fixer (e)** to fix the pedal plate.

② Manipulate the pedal plate knob (see picture) so that it would be in firm contact with the floor on which the piano is installed.

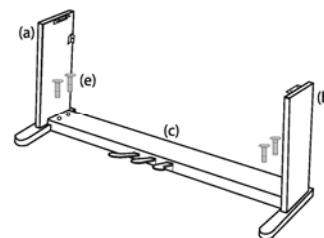

### 2 Assembling the backplate

① Place the **backplate (d)** between the leg by inserting it from behind.

② Use the **backplate fixer (f), (g)** to fix the backplate.

③ Make sure that the plate is maintaining the right angle.

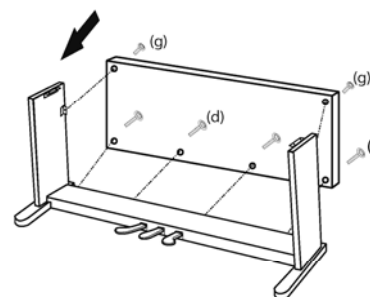

### 3 Assembling the main body

- 1 Place the main body onto the assembled lower body by pushing it from behind so that the screws (2 EA) fixed under the main body would fit into the rear holes of the brackets attached to the legs.
- 2 Use **main body fixer (h)** screws on the other holes of the brackets to secure the connection between the bodies.
- 3 Firmly tighten all 4 screws to finish the assembly.

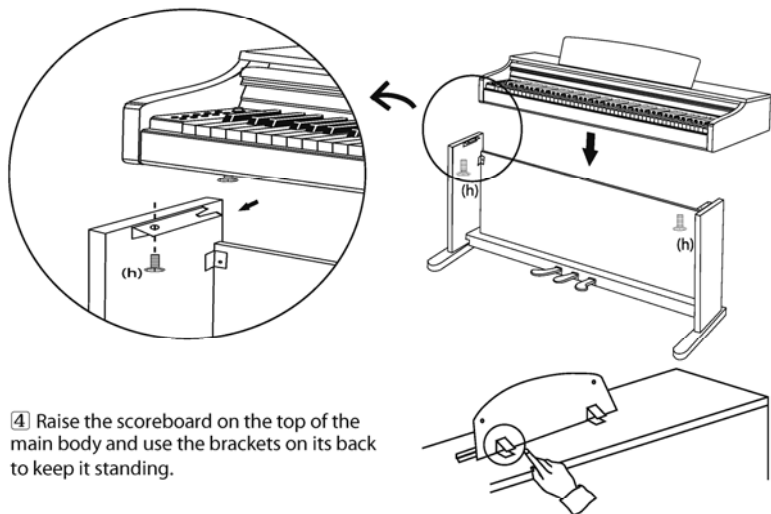

- 4 Raise the scoreboard on the top of the main body and use the brackets on its back to keep it standing.

### 4 Connecting the pedal & power cables

- 1 Connect the pedal cable from the pedals to the pedal jack beneath the main body. The pedal cable is tied below the pedal box.

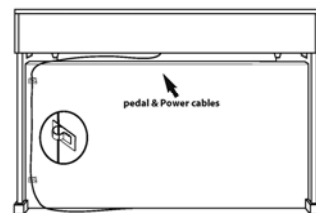
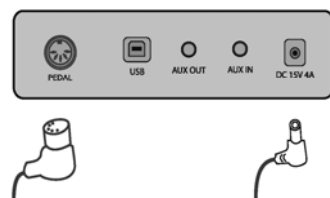

## Parts

### Power Switch



Connect the AC power cord to the piano and a household AC outlet, and press the **power** switch to turn on the piano. The buttons will be lighted.

- ⇒ When the piano is turned on, the initial default voice is 'Grand Piano 1'.
- ⇒ The 'Reverb' and 'EXV' buttons are lighted, and these features are activated by default.
- ⇒ When turning on the piano, do not press the sustain pedal. Doing so will cause the pedal not to function properly.

All parameters and settings except for the recording memory are reset whenever the piano is turned off and on again.

#### Auto Power Off (APO)

This product is designed to turn itself off automatically when left unused for more than 30 minutes, in order to conserve energy.

#### Deactivating Auto Power Off (APO)

While holding down the first white key and first black key from the left, press the power switch to deactivate APO.

### Headphone jacks

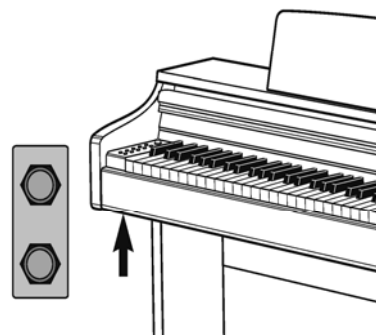

Two headphone jacks are located beneath the main body to the left.

- ⇒ When a headphone is connected to the piano, the speakers of the piano stop sounding.
- ⇒ Two headphone jacks are offered, supporting two people to simultaneously listen to the piano.
- ⇒ The type of headphones used is Stereo 55 (1/4 inch). If the use of the 3.5mm plugged headphones is desired, an extra converter (3.5mm -> 55) will be required.
- ⇒ Headphones are sold separately.

## Connecting with External Devices

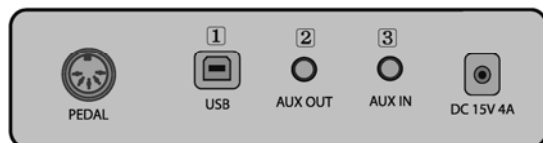

Outgoing Jacks (located on the back of the main body)

### 1 Connecting to a computer (via USB Terminal)

The piano has a USB jack which may be used to connect the piano directly to a computer. Through this jack the piano can exchange MIDI and audio streaming data with computers via USB.

- 1 Use a USB cable (sold separately) to connect the piano to the computer.
- 2 To use the piano as a MIDI device, Run the MIDI software installed on the computer, and set the input/output device of the software to the USB audio device.
- 3 To use the piano as an audio device, connect it to the computer via USB and set the computer's audio device to the piano.

- ⇒ Some notes may be lost when connected via USB.
- ⇒ The piano's performance may be digitally recorded by the computer when being used as an audio device.
- ⇒ Usable on Windows XP or higher, and Mac OS X.
- ⇒ No extra driver is required since it utilizes the common Windows device driver.
- ⇒ If the device is not recognized, or the USB audio device is not seen on the list of the MIDI device setup menu, check the USB cable and its connection state.
- ⇒ If connecting the instrument to a computer causes the computer to shut off or stop functioning, do not reattempt the connection and immediately contact customer service.

### 2 Audio Output (AUX OUT)

This jack is used when the use of a more powerful external sound producer (amplifiers etc.) is desired to reproduce the audio output of the piano.

Use an audio cable (sold separately) to connect the AUX OUT of the piano and the input jack of the external device to hear the piano through the external device.

- ⇒ When connecting to an external device, always turn on the external device first before turning on the power of the piano. When quitting the use of the external device, reverse the order and turn the piano off first before turning off the external device.
- ⇒ The audio connection jacks are stereo 3.5mm connectors.

### 3 Audio Input (AUX IN)

By utilizing this jack, the piano can play soundtracks provided by external sources through its internal speakers.

Use an audio cable (sold separately) to connect the audio output jack of the external devices (MP3 player, CD player, sound module, electric instrument etc.) and the AUX IN of the piano to hear the sound of the external device played through the piano's internal speakers.

- ⇒ When connecting to an external device, always turn on the external device first before turning on the power of the piano. When quitting the use of the external device, reverse the order and turn the piano off first before turning off the external device.
- ⇒ The audio connection jacks are stereo 3.5mm connectors.

## Pedals

The piano consists of three pedals that correspond to the three pedals of an acoustic piano.

### Connecting the pedal cable

Release the pedal cable tied below the pedal box, and connect it to the pedal jack located below the main body.



### Pedal Functions

#### 1 Sustain Pedal (Right Pedal)

This pedal performs the same function as the sustain pedal of an acoustic piano; playing notes while keeping this pedal pressed will sustain the notes even if the keys are released.

- ⇒ The duration of the sustained notes differs depending on the chosen voice.
- ⇒ The **Half Pedal** feature allows the instrument to reproduce the delicate control the acoustic piano performers exercise on their instruments by pressing the pedal only halfway.
- ⇒ When turning on the piano, do not press the sustain pedal. Doing so will cause the pedal not to function properly.

#### 2 Sostenuto Pedal (Middle Pedal)

This pedal performs the same function as the sostenuto pedal, which is the middle pedal of an acoustic grand piano. It behaves similarly to the sustain pedal, but only the notes that are being played at the moment the sostenuto pedal is pressed will be retained. Notes that are played after the pedal was pressed are not affected, even if the pedal is being kept pressed.

#### 3 Soft Pedal (Left Pedal)

This pedal performs the same function as the soft pedal of an acoustic piano. Pressing this pedal causes the sound of the piano to be muffled a little bit and softens its character.

- ⇒ This pedal is used also for special effects of the EXV feature when the voice is set to Elec Organ 1/2, Strings or Slow Strings. (Refer to the EXV section on page 16.)

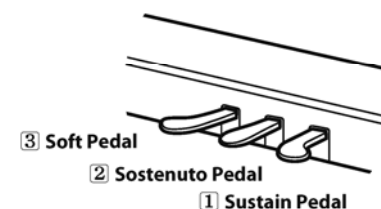

Control Panel



- a MASTER VOLUME ..... Page 13
- b LAYER Button ..... Page 14
- c SPLIT Button ..... Page 15
- d EXV Button ..... Page 16
- e TWIN PIANO Button ..... Page 17
- f REVERB Button ..... Page 17
- g DEMO/EDU MUSIC Button..... Page 20
- h RECORD Button ..... Page 19
- i PLAY/STOP Button ..... Page 19,20
- j METRONOME Button ..... Page 18
- k SETUP Button ..... Page 20, 25, 26

Voice KEYMAP

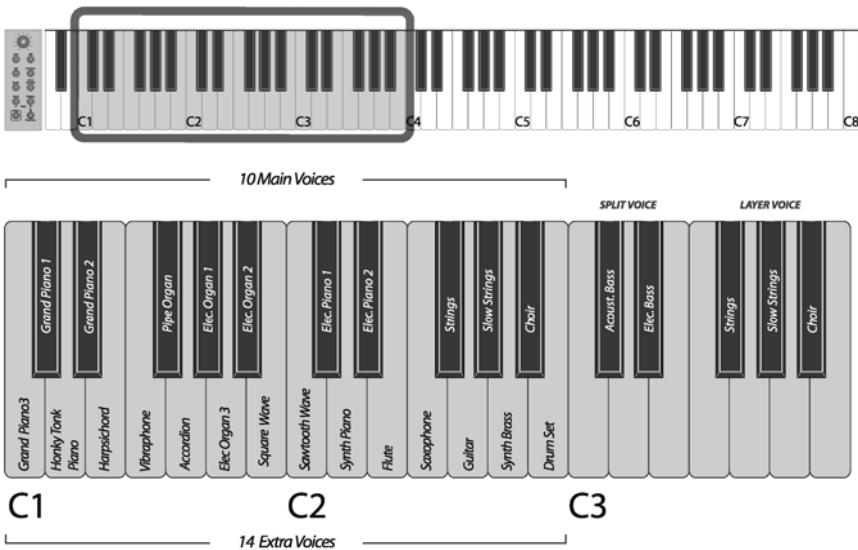

Function KEYMAP

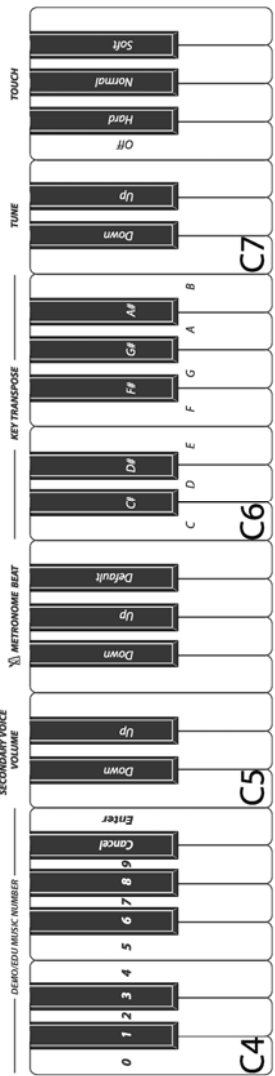

## Basic Controls

### Adjusting Main Volume

Use the **Master Volume knob** to adjust the overall volume of the piano.

⇒ The main volume also affects headphones.



### Choosing Voice

This product is a high class digital piano which offers the refined deep sound of quality acoustic grand pianos along with the sound of other diverse instruments including that of electric musical instruments.

The voices consist of 10 main voices, 2 split voices, 3 layer voices and 14 extra voices.

- ⇒ **Main Voices**  
Grand piano 1/2, pipe organ, elec. organ 1/2, elec. piano 1/2, strings, slow strings, choir
- ⇒ **Split Voices**  
Acoustic bass, Elec. bass
- ⇒ **Layer Voice**  
Strings, slow strings, choir
- ⇒ **Extra Voice**  
Grand piano 3, Honky Tonk Piano, harpsichord, vibraphone, accordion, elec. organ 3, square wave, sawtooth wave, synth piano, flute, saxophone, guitar, synth bass, percussions
- ⇒ **GM (General MIDI) Voices**  
The piano is capable of interpreting the MIDI standards, and once connected to a computer it is able to exploit the full range of the 128 General MIDI voices.

#### 1 Press SETUP.

⇒ The button will be lighted.

#### 2 While holding down SETUP, press the key that corresponds to the desired voice.

⇒ The key should be pressed while SETUP button is being held down.

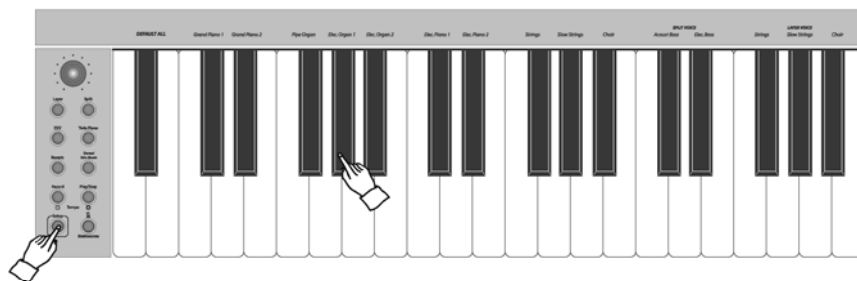

- ⇒ The initial default voice is Grand Piano 1.
- ⇒ The EXV(Expanded Voice) feature is available only for the 10 main voices.
- ⇒ Refer to the Voice KEYMAP of the page 11 for key-voice assignments.
- ⇒ When a Split or Layer voice is chosen, the corresponding feature - Split or Layer - will be activated automatically. (Refer to the section on LAYER/SPLIT, on page 14~15.)

## Layer

Layer allows the player to sound two voices simultaneously while playing the keyboard.

### Using Layer

#### 1 Choose the desired main voice first.

Refer to page 13 for voice selection.

#### 2 Press LAYER.

The button will be lighted, indicating that the Layer mode is active.

⇒ Choosing a Layer voice via voice selection will also activate the Layer mode.

#### 3 Choose the desired Layer voice.

While holding down **SETUP**, press a key that corresponds to a voice that belongs to the Layer voice group. Refer to page 13 for voice selection.



### Adjusting the Layer volume

Adjusting the volume of the Layer voice can balance the volumes of the main and Layer voices.

#### 1 Press LAYER.

The button will be lighted, indicating that the Layer mode is active.

#### 2 Adjust the Layer volume.

While holding **SETUP**, adjust the Layer volume by pressing the **Secondary Voice Volume Up(D#4)/Down(C#4)** keys.

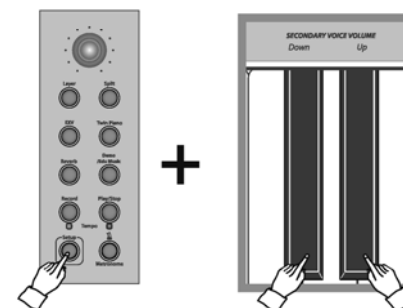

- ⇒ Refer to the Function KEYMAP of page 12 for key-function assignments.
- ⇒ Pressing both **Up and Down** keys simultaneously will restore its default value (11).
- ⇒ The numerical range of the volume is from 0 to 16.
- ⇒ The volume is increased or decreased by 1 per one key press.
- ⇒ Keep a key pressed to quickly navigate through the values.



## Split

Split divides the piano keyboard into two sections, and allows the player to assign different voices to each of the sections. For example, by using Split the melody part on the right could be played in piano voice while the accompaniment on the left sounding in acoustic bass voice.

### Using Split

#### 1 Choose the desired main voice first.

The main voice will be the 'right' voice. Refer to page 13 for voice selection.

#### 2 Press SPLIT.

The button will be lighted, indicating that the **Split** mode is active.

⇒ Choosing a Split voice via voice selection will also activate the Split mode.

#### 3 Choose the desired Split voice.

While holding down **SETUP**, press a key that corresponds to a voice that belongs to the Split voice group. Refer to page 13 for voice selection.

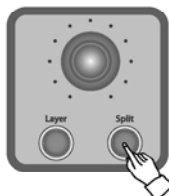

### Adjusting the Split (left part) volume

Adjusting the volume of the split voice can balance the volumes of the main (right) and Split (left) voices.

#### 1 Press SPLIT.

The button will be lighted, indicating that the Split mode is active.

#### 2 Adjust the Split volume.

While holding **SETUP**, adjust the Split volume by pressing the **Secondary Voice Volume Up(D#4)/Down(C#4)** keys.

- ⇒ Refer to the Function KEYMAP of page 12 for key-function assignments.
- ⇒ Pressing both **Up and Down** keys simultaneously will restore its default value (11).
- ⇒ The numerical range of the volume is from 0 to 16
- ⇒ Keep a key pressed to quickly navigate through the values.

### Setting the Split Point

The split point determines the point by which the keyboard is divided when using Split, and is adjustable to match preferences.

While holding **SPLIT**, press the key that you wish to set as the split point.

⇒ The default split point is F#3 (third F# from the left).

▼ Split point (Default F#3)



## Expanded Voice (EXV)

The Expanded Voice (EXV) is a feature that allows a more diverse and dynamic sound to be produced out of the 10 main voices; the ones that are assigned to the black keys. When this is active, 1~4 groups of sound layers are added to the main voices so that the player is able to experience the optimized sound effects of each voice.

### List of EXV Effects

Voice	EXV Effects/Additions	Sound Effect	
		Reverb	Effect
Grand piano 1	8 sound layers that differ depending on the velocity of playing	○	-
Grand piano 2	6 sound layers that differ depending on the velocity of playing	○	-
Pipe Organ	An extra sound layer consisting of a separate sample of pipe organ sound	○	-
Elec Organ 1	4 sound layers which allow for vibrato expressions when strongly playing Left pedal toggles the chorus effect	○	-
Elec Organ 2	A couple of layers designed to emphasize the harmonic components allowing for the reproduction of the deep electric organ sound Left pedal toggles the chorus effect	○	-
Elec Piano 1	Expression of three groups of sounds that differ depending on the velocity of playing	○	-
Elec Piano 2	An extra layer of electric piano harmonics sampled separately	○	○
Strings	When strongly playing wind instrument sound is added Left pedal plays cymbal sound	○	-
Slow Strings	When strongly playing wind instrument sound is added Left pedal plays cymbal sound	○	-
Choir	4 sound layers consisting of separate samples of mixed-gender choir	○	○

### Using EXV

#### 1 Choose one of the 10 main voices. (Refer to page 13 for voice selection)

- ⇒ **Main voice:**  
Voices indicated on the panel  
(Grand piano 1/2, pipe organ, elec. organ 1/2, elec. piano 1/2, strings, slow strings, choir)
- ⇒ The EXV is activated by default when the piano is first turned on.
- ⇒ Grand piano 1 has the **EXV** internalized, and retains the EXV effect even if the EXV button is turned off.
- ⇒ The EXV affects only the 10 main voices, and cannot be used for the other voices (14 extra voices, 3 layer voices, 2 split voices).

#### 2 To deactivate the EXV, press EXV.

The button light will be off, indicating that EXV is deactivated.

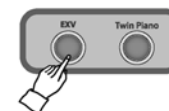

### Left Pedal Functions while using EXV

Elec Organ 1/2: Chorus expression  
Strings, Slow Strings: Cymbals

## Twin Piano

Twin Piano divides the piano keyboard into two equal smaller ("twin") keyboards that shares the same range of octaves. This allows two people to play the piano simultaneously on the same octave range.

### 1 Press TWIN PIANO.

The keyboard is divided by the 'D#4' key (see below), into two equal sections with identical range of octaves.

⇒ The pedals work only for the Piano 2 section.

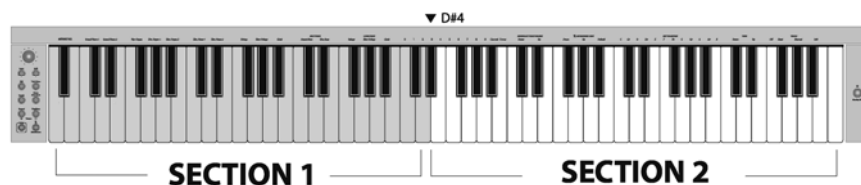

### 2 Press TWIN PIANO once more to quit TWIN PIANO mode.

The button light will go out, indicating that Twin Piano is no more active.

## Default All

Default All allows the user to reset all of the piano's parameters to its default value at once. This allows for a convenient reset without having to turn the piano off and on again.

While holding down **SETUP**, press the **DEFAULT ALL(B<sub>b</sub>)** key. All parameters described below will be restored to their default values.

Parameter	Default	Range
Secondary Voice Volume	11	0 ~ 16
Metronome Beat	4	0, 2 ~ 13
Metronome Tempo	128	40 ~ 250
Transpose	C	G~C~F#
Tune	A4 440Hz	-50 ~ 0 ~ 50 cent
Touch	Normal	Off, Hard, Normal, Soft

⇒ Performing Default All does not reset the voice selection.

## Reverb

Reverb recreates the decaying reflections of sound as experienced in a fully resonant concert hall, making the piano sound be more natural and realistic.

### Using Reverb

#### 1 Press REVERB.

⇒ The Reverb is initially set ON by default when the piano is first turned on, indicated by the button light.

#### 2 To deactivate Reverb, press REVERB again.

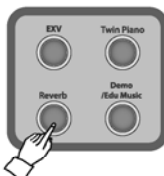

## Metronome

Metronome provides clicks over a steady beat to help the player keep in time while playing.

### Turning Metronome On/Off

Press **METRONOME** to start the metronome. The button will be lighted. Press **METRONOME** again to turn off the metronome. The button will be turned off.



### Adjusting Tempo

The tempo range of the metronome is from 40 to 250 beats per minute. While the metronome is active, press **Tempo +/-** button to adjust its tempo.

- ⇒ The tempo is increased or decreased by 1 bpm (beats per minute) per one button click.
- ⇒ Keep + or - button pressed to quickly navigate through the values.
- ⇒ Pressing + and - buttons simultaneously will restore its default value (128).

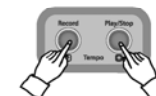

### Setting Beats

While holding down **SETUP**, press **Metronome Beat Up(G#5)/Down(F#5)** keys.

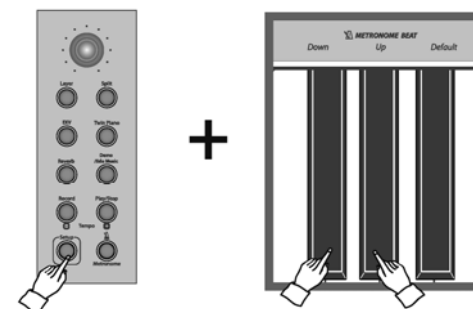

- ⇒ Refer to page 12 for the key-function assignments.
- ⇒ **Available beats:** 0, 2, 3, 4, 5, 6, 7, 8, 9, 10, 11, 12, 13
- ⇒ **Default value:** 4
- ⇒ Pressing **Metronome Beat Default(A#5)** key while holding down **SETUP** will restore the default beat value (4).

## Record

The piano offers extensive recording functions to record what is played on it. Its memory system is capable of saving up to 6,500 notes, an amount that can save 'Für Elise' by L. V. Beethoven five times in a row.

### Recording & Playing

A performance may be recorded using the recording function.

#### Recording

##### 1 Press RECORD.

The button will be lighted.

→ If the piano memory contains any previously recorded music, it must be cleared before recording new material.



##### 2 Begin playing the piano to begin recording.

- Pressing **PLAY/STOP** will also begin recording. Use this when wishing to insert rests at the beginning.
- Layer/Split may be used for recording.
- Metronome is usable during recording, but its sound will not be recorded.
- Maximum capacity is about 6,500 notes. The recording will terminate when this limit is exceeded.
- RECORD button will be flashing while recording.

##### 3 Press RECORD or PLAY/STOP again to stop recording.

#### Playing Recorded Music

##### 1 While the RECORD button is lighted, press PLAY/STOP.

The RECORD and PLAY/STOP buttons will be lighted. Once the playback begins, the PLAY/STOP button will be flashing.

- To remove what is recorded, press and hold down **RECORD** for 2-3 seconds. The piano will sound a 'bell' to indicate that its memory is cleared.
- When there is no previously recorded material, only **RECORD** button will be lighted.
- When there is previously recorded material, both **RECORD** and **PLAY/STOP** buttons will be lighted to indicate it.
- The recorded material will be retained even if the piano has been turned off.
- While in record mode, the settings of the piano, including voice selection, may not be adjusted.

##### 2 Press RECORD once again to quit recording mode.

## Demo/Education Music

The piano offers a large bank of recorded demo music that could be listened to by the user for listening pleasure or educational purpose. The range of recorded pieces is extensive, including the series of educational etudes by the music educator Czemy and others as well as selected works by long beloved composers like Chopin and Mozart.

### Choosing and playing a demo work

The bank of demo music includes a large number of works by various composers, all recorded by professional pianists.

All included works except reference number 1-50 have their melody and accompaniment parts internally divided, so that users can listen to each part separately if desired.

#### 1 Enter Demo/Edu Music mode.

Press **DEMO/EDU MUSIC**. The button will be lighted to indicate that it is in Demo/Edu mode.

→ Pressing **PLAY/STOP** will play the first piece on the demo list (Chopin Etude Op.10, No.1).

#### 2 Refer to the demo list to choose the desired music to play.

Press and hold down **SETUP**, and press the keys corresponding to each digit of the reference number of the desired piece, followed by the **ENTER** key (B4). The chosen piece will be played immediately.

For example, to choose the 5th etude of Burgmüller's 25 Etudes to which is referred by the reference number 605, press and hold down **SETUP**, and:

- 1 Press 6 (F#4), then
- 2 0 (C4), then
- 3 5 (F4), then
- 4 **ENTER**(B4). The chosen piece will be played immediately.

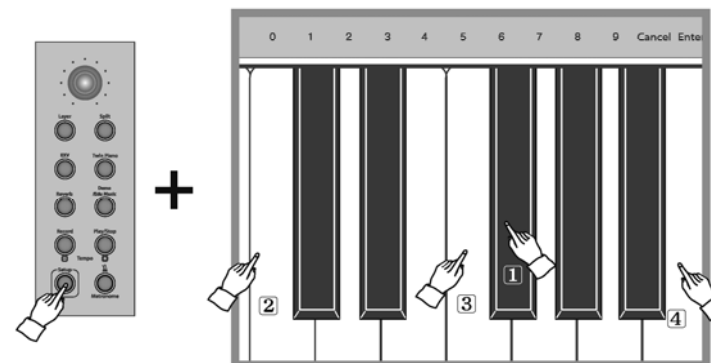

#### 3 Press Play/Stop to either play or stop the demo performance.

- When a piece is finished, it is followed by the next piece on the demo list.
- If desiring to separately hear a single part (melody or accompaniment), press Left Pedal to cycle through the available part playing options. The order of the cycle is: Melody + Acc. ► Melody Only ► Acc. Only. Works referenced as numbers from 1 to 50 do not support the part playing options.

### Adjusting the volume of demo performance

The volume of the demo performance can be adjusted to match preferences.

- While in Demo/Edu Music mode, press and hold down **SETUP**, and press **Secondary Volume Up(D#5)/Down(C#5)** keys to adjust demo performance volume. (0~16)
- Pressing both **Up** and **Down** keys simultaneously will restore its default value (11).
- Keep Up or Down key pressed to quickly navigate through the values.

## Demo/Education Music

### Selected Works by Composer (1~50)

No.	Tilte	Composer
1	Etude op.10 no.1	<b>Chopin, Fryderyk Francuszek</b>
2	Etude op.10 no.4	
3	Etude op.10 no.5	
4	Etude op.10 no.9	
5	Nocturne op.9 no.1	
6	Nocturne op.9 no.2	
7	Nocturne op.27 no.2	
8	Nocturne op.32 no.1	
9	Nocturne op.72 no.1	
10	Sonata op.3 no.4	
11	Mazurka op.7 no.1	
12	Mazurka op.30 no.2	
13	Mazurka op.67 no.3	
14	Polonaise op.40 no.1	
15	Waltz op.34 no.1	
16	Waltz op.64 no.1	
17	Waltz op.64 no.2	
18	Waltz op.69 no.2	
19	Impromptu - No.4 c-sharp minor (fantasie-Impromptu) Op.66	
20	Ballade op.23 no.1 in g minor	
21	Ballade op.47 no.3 in A flat Major	
22	Prelude op.28 no.1 in C Major- Agitato	
23	Prelude op.28 no.16 in b-flat minor- Presto con fuoco	
24	Piano Sonata no.10 in C major, KV 330-1 Allegro moderato	<b>Mozart, Wolfgang Amadeus</b>
25	Piano Sonata no.11 in A major, KV331-3 Alla turca : Allegretto	
26	Piano Sonata no.14 in C minor, KV457-2 Adagio	
27	Piano Sonata no.14 in C minor, KV457-3 Allego assai	
28	Variations "Ah! Vous dirai-je, Manan"	
29	Rondo in D major, KV485	<b>Beethoven, Ludwig van</b>
30	Sonate no.8 in c minor, op.13 'Pathetique' Grave- Allegro molto e con brio	
31	Sonate no.8 in c minor, op.13 'Pathetique' 2 Adagio cantabile	
32	Sonate no.8 in c minor, op.13 'Pathetique' 3 Allegro	<b>Debussy, Claude Achille</b>
33	Arabesque No.1 in E major	
34	Suite bergamesque 1. Prelude	
35	Suite bergamesque 3. Clair de lune	
36	Petite Suite, for piano 4-hands 2. Cortege	<b>Schumann, Robert Alexander</b>
37	Scenes from Childhood op.15 From foreign lands and peoples in G major	
38	"12 Etudes d'execution transcendante (Transcendental Etudes), S139 Etue Transcendante in d minor, Mazepa	<b>Liszt, Franz</b>
39	The flight of the bumble bee (by S. Rachmaninov)	<b>Rimsky, Korsakov</b>
40	Trois Gymnopedies 1. Lent et douloureux	<b>Satie, Erik</b>
41	12 Fantasie per clavicembalo (TWV 33) - Harpsichord music - 1. Fantasia	<b>Telemann, Georg Philipp</b>
42	12 Fantasie per clavicembalo (TWV 33) - Harpsichord music - 3. Fantasia	
43	12 Fantasie per clavicembalo (TWV 33) - Harpsichord music - 5. Fantasia	
44	12 Fantasie per clavicembalo (TWV 33) - Harpsichord music - 6. Fantasia	
45	12 Fantasie per clavicembalo (TWV 33) - Harpsichord music - 12. Fantasia	
46	Children's Album, Op.39 No.4 Mama	<b>Tchaikovsky, Pyotr Ilyich</b>
47	Prelude in C major, BWV933	<b>Bach, Johann Sebastian</b>
48	Preludium und Fuge in B BWV560- Pipe Organ music-	
49	Wohltemperiertes Klavier-Pledudio 1	
50	Wohltemperiertes Klavier-Fuga 1	

## Demo/Education Music

## Beyer / Czerny Etude Series (101 ~ 540)

No.	Series	No.	Series	No.	Series	No.	Series
	<b>Beyer</b>	176	Beyer 76	344	Czerny 100-44	418	Czerny 30-18
101	Beyer 1	177	Beyer 77	345	Czerny 100-45	419	Czerny 30-19
102	Beyer 2	178	Beyer 78	346	Czerny 100-46	420	Czerny 30-20
103	Beyer 3	179	Beyer 79	347	Czerny 100-47	421	Czerny 30-21
104	Beyer 4	180	Beyer 80	348	Czerny 100-48	422	Czerny 30-22
105	Beyer 5	181	Beyer 81	349	Czerny 100-49	423	Czerny 30-23
106	Beyer 6	182	Beyer 82	350	Czerny 100-50	424	Czerny 30-24
107	Beyer 7	183	Beyer 83	351	Czerny 100-51	425	Czerny 30-25
108	Beyer 8	184	Beyer 84	352	Czerny 100-52	426	Czerny 30-26
109	Beyer 9	185	Beyer 85	353	Czerny 100-53	427	Czerny 30-27
110	Beyer 10	186	Beyer 86	354	Czerny 100-54	428	Czerny 30-28
111	Beyer 11	187	Beyer 87	355	Czerny 100-55	429	Czerny 30-29
112	Beyer 12	188	Beyer 88	356	Czerny 100-56	430	Czerny 30-30
113	Beyer 13	189	Beyer 89	357	Czerny 100-57		
114	Beyer 14	190	Beyer 90	358	Czerny 100-58		<b>Czerny 40</b>
115	Beyer 15	191	Beyer 91	359	Czerny 100-59	501	Czerny 40-1
116	Beyer 16	192	Beyer 92	360	Czerny 100-60	502	Czerny 40-2
117	Beyer 17	193	Beyer 93	361	Czerny 100-61	503	Czerny 40-3
118	Beyer 18	194	Beyer 94	362	Czerny 100-62	504	Czerny 40-4
119	Beyer 19	195	Beyer 95	363	Czerny 100-63	505	Czerny 40-5
120	Beyer 20	196	Beyer 96	364	Czerny 100-64	506	Czerny 40-6
121	Beyer 21	197	Beyer 97	365	Czerny 100-65	507	Czerny 40-7
122	Beyer 22	198	Beyer 98	366	Czerny 100-66	508	Czerny 40-8
123	Beyer 23	199	Beyer 99	367	Czerny 100-67	509	Czerny 40-9
124	Beyer 24	200	Beyer 100	368	Czerny 100-68	510	Czerny 40-10
125	Beyer 25	201	Beyer 101	369	Czerny 100-69	511	Czerny 40-11
126	Beyer 26	202	Beyer 102	370	Czerny 100-70	512	Czerny 40-12
127	Beyer 27	203	Beyer 103	371	Czerny 100-71	513	Czerny 40-13
128	Beyer 28	204	Beyer 104	372	Czerny 100-72	514	Czerny 40-14
129	Beyer 29	205	Beyer 105	373	Czerny 100-73	515	Czerny 40-15
130	Beyer 30	206	Beyer 106	374	Czerny 100-74	516	Czerny 40-16
131	Beyer 31		<b>Czerny 100</b>	375	Czerny 100-75	517	Czerny 40-17
132	Beyer 32			376	Czerny 100-76	518	Czerny 40-18
133	Beyer 33	301	Czerny 100-1	377	Czerny 100-77	519	Czerny 40-19
134	Beyer 34	302	Czerny 100-2	378	Czerny 100-78	520	Czerny 40-20
135	Beyer 35	303	Czerny 100-3	379	Czerny 100-79	521	Czerny 40-21
136	Beyer 36	304	Czerny 100-4	380	Czerny 100-80	522	Czerny 40-22
137	Beyer 37	305	Czerny 100-5	381	Czerny 100-81	523	Czerny 40-23
138	Beyer 38	306	Czerny 100-6	382	Czerny 100-82	524	Czerny 40-24
139	Beyer 39	307	Czerny 100-7	383	Czerny 100-83	525	Czerny 40-25
140	Beyer 40	308	Czerny 100-8	384	Czerny 100-84	526	Czerny 40-26
141	Beyer 41	309	Czerny 100-9	385	Czerny 100-85	527	Czerny 40-27
142	Beyer 42	310	Czerny 100-10	386	Czerny 100-86	528	Czerny 40-28
143	Beyer 43	311	Czerny 100-11	387	Czerny 100-87	529	Czerny 40-29
144	Beyer 44	312	Czerny 100-12	388	Czerny 100-88	530	Czerny 40-30
145	Beyer 45	313	Czerny 100-13	389	Czerny 100-89	531	Czerny 40-31
146	Beyer 46	314	Czerny 100-14	390	Czerny 100-90	532	Czerny 40-32

## Burgmuller 25 Etudes / Sonatines (601 ~ 745)

No.	Title	No.	Title	Composer
601	Burgmuller 25 Etude No.1 <i>La Candeur</i>	701	Sonatine op.20 no.1 1	F. Kuhlau
602	Burgmuller 25 Etude No.2 <i>L'Arabesque</i>	702	Sonatine op.20 no.1 2	
603	Burgmuller 25 Etude No.3 <i>La Pastorale</i>	703	Sonatine op.20 no.1 3	
604	Burgmuller 25 Etude No.4 <i>Patite Reunion</i>	704	Sonatine op.20 no.2 1	
605	Burgmuller 25 Etude No.5 <i>Innocence</i>	705	Sonatine op.20 no.2 2	
606	Burgmuller 25 Etude No.6 <i>Progres</i>	706	Sonatine op.20 no.2 3	
607	Burgmuller 25 Etude No.7 <i>Le Courant Limpide</i>	707	Sonatine op.20 no.3 1	
608	Burgmuller 25 Etude No.8 <i>La Gracieuse</i>	708	Sonatine op.20 no.3 2	
609	Burgmuller 25 Etude No.9 <i>La Chasse</i>	709	Sonatine op.20 no.3 3	
610	Burgmuller 25 Etude No.10 <i>Tendre Fleur</i>	710	Sonatine op.55 no.1 1	
611	Burgmuller 25 Etude No.11 <i>La Bergeronnette</i>	711	Sonatine op.55 no.1 2	
612	Burgmuller 25 Etude No.12 <i>L'Adieu</i>	712	Sonatine op.55 no.2 1	
613	Burgmuller 25 Etude No.13 <i>Consolation</i>	713	Sonatine op.55 no.2 2	
614	Burgmuller 25 Etude No.14 <i>La Styrienne</i>	714	Sonatine op.55 no.2 3	
615	Burgmuller 25 Etude No.15 <i>Ballade</i>	715	Sonatine op.55 no.3 1	
616	Burgmuller 25 Etude No.16 <i>Douce Plainte</i>	716	Sonatine op.55 no.3 2	
617	Burgmuller 25 Etude No.17 <i>La Babillarde</i>	717	Sonatine op.36 no.1 1	M. Clementi
618	Burgmuller 25 Etude No.18 <i>Inquietude</i>	718	Sonatine op.36 no.1 2	
619	Burgmuller 25 Etude No.19 <i>Ave Maria</i>	719	Sonatine op.36 no.1 3	
620	Burgmuller 25 Etude No.20 <i>Tarantelle</i>	720	Sonatine op.36 no.2 1	
621	Burgmuller 25 Etude No.21 <i>L'Harmonie Des Anges</i>	721	Sonatine op.36 no.2 2	
622	Burgmuller 25 Etude No.22 <i>Barcarolle</i>	722	Sonatine op.36 no.2 3	
623	Burgmuller 25 Etude No.23 <i>Le Retour</i>	723	Sonatine op.36 no.3 1	
624	Burgmuller 25 Etude No.24 <i>L'hirondelle</i>	724	Sonatine op.36 no.3 2	
625	Burgmuller 25 Etude No.25 <i>La Chevaleresque</i>	725	Sonatine op.36 no.3 3	
		726	Sonatine op.36 no.4 1	
		727	Sonatine op.36 no.4 2	
		728	Sonatine op.36 no.4 3	
		729	Sonatine op.36 no.5 1	
		730	Sonatine op.36 no.5 2	
		731	Sonatine op.36 no.5 3	
		732	Sonatine op.36 no.6 1	J. Haydn
		733	Sonatine op.36 no.6 2	
		734	Sonatine Hob. 16-35 1	
		735	Sonatine Hob. 16-35 2	W.A. Mozart
		736	Sonatine Hob. 16-35 3	
		737	Sonatine K.545 1	
		738	Sonatine K.545 2	L.V. Beethoven
		739	Sonatine K.545 3	
		740	Sonatine op.49 no.2 1	
		741	Sonatine op.49 no.2 2	
		742	Sonatine op.49 no.1 1	J.L. Dussek
		743	Sonatine op.49 no.1 2	
		744	Sonatine op.20 no.1 1	
		745	Sonatine op.20 no.1 2	

A number of different adjustable parameters are included, in order to allow advanced adjustments of the properties of the piano.

## Setting the Parameters

## Transpose

The piano may be transposed by units of semitone, in order to either match the range of a singer's voice without necessitating change of fingering or facilitate playing music written in difficult keys.

While holding down **SETUP**, press the desired key to which you wish to transpose your C.

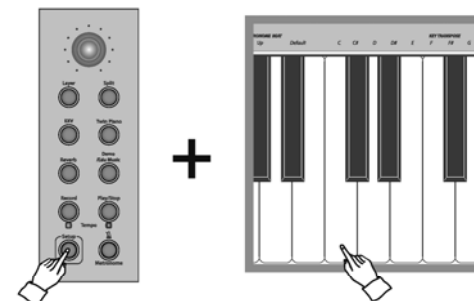

- Refer to page 12 for the key-function assignments.
- **Default value:** C
- **Range:** Total range of 12 semitones (1 octave), G ~ C ~ F#
- The last adjusted value of Transpose will persist until either another change is made to it, or the piano is turned off.

## Tune

Tune allows the fine tuning of the piano by units of cent, when the piano is to be played alongside other acoustic instruments that are tune-sensitive.

While holding down **SETUP**, press **Tune Up(D#7)/Down(C#7)** keys.

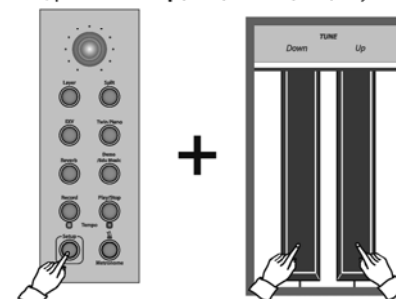

- Refer to page 12 for the key-function assignments.
- When the **Tune Up/Down** keys are pressed, it will play a 'C' note as adjusted by the tuning. The user can use this as a reference note for tuning.
- Pressing both **Up/Down** keys simultaneously will restore its default value (A4=440Hz).
- The range of Tune is  $\pm 50$ cents from the A4=440Hz standard.
- Keep a key pressed to quickly navigate through the values.
- The last adjusted value of Tune will persist until either another change is made to it, or the piano is turned off.
- **Cent:** A unit of pitch; 1 cent equals to a hundredth of a semitone.
- **Hertz(Hz):** A unit of vibration; it represents the number of repetition occurring in a second during an iterative movement by an object or a wave.

## Touch

Touch determines how responsive the sound volume is to the playing strength or velocity of the player. The piano offers four different Touch settings to satisfy different types of music or player preferences.

### Setting Touch

While holding **SETUP**, press the desired **TOUCH(Off, Soft, Normal, Hard)** key.

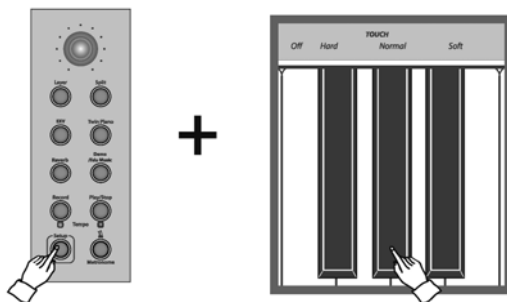

- Refer to page 12 for the key-function assignments
- The default value is **Normal**.
- The piano offers 4 touch settings: Off, Soft, Normal, Hard.

#### Off(F#7)

Under this unique setting, all notes are pronounced equally regardless of the player's finger velocity. It is used when playing voices like Organ, an instrument whose volume is not related to the velocity of its keys.

#### Hard(F#7)

This setting requires the player to play quite hard to produce loud sounds, and suits players that possess strong fingers or desire more delicate control of soft melodies.

#### Normal(G#7 - Default)

It represents the responsiveness of ordinary acoustic pianos, and is the default value.

#### Soft(A#7)

The Soft setting allows the player to produce large sound without necessarily using large forces, and is designed to suit players who do not have much finger strength.

## MIDI

MIDI stands for 'Musical Instrument Digital Interface', and is the international standard for the exchange of musical data between a computer and an instrument, or two instruments.

### MIDI Local Control

In general, MIDI Local Control refers to the connection between the keyboard and the piano's internal sound source. When Local Control is set to Off, the input data from keyboard is sent not to the internal system and only to the external device connected via USB. Therefore, playing the piano with Local Control set to Off will produce no sound if a PC or other external MIDI device is not properly connected.

While holding down **SETUP**, press the rightmost key (**C8**) to toggle MIDI Local Control On/Off. (Default ON)

## MIDI Implementation Chart

### MIDI Implementation Chart

Function			Recognized	Transmitted	Remark
Basic Channel	Default		ALL	1-3	
Mode	Default		OMNI OFF, POLY	OMNI OFF, POLY	
Note ON/OFF	9nH kk w		O	O	#kk:note ON (0-127) #w:velocity (1-127)
Pitch Bender	EnH bi bh		O	O	Maximum swing +/- 1 tone
Control Change	00	BnH 00H cc	O	X	Bank Select
	01	BnH 01H cc	O	X	Modulation Wheel
	05	BnH 05H cc	O	X	Portamento Time
	06	BnH 06H cc	O	X	Data Entry
	07	BnH 07H cc	O	X	Volume
	10	BnH 0AH cc	O	X	Pan Out
	11	BnH 0BH cc	O	X	Expression
	64	BnH 40H cc	O	O	Sustain (Damper) Pedal
	65	BnH 41H cc	O	X	Portamento ON/OFF
	66	BnH 42H cc	O	O	Sostenuto Pedal
	67	BnH 43H cc	O	O	Soft Pedal
	80	BnH 80H vv	O	X	Reverb Prog.(vv=00H-70H)
	81	BnH 51H vv	O	X	Chorus Prog.
	91	BnH 5BH vv	O	O	Reverb Send Level
	93	BnH 5DH vv	O	O	Chorus Send Level
	120	BnH 78H 00H	O	X	All Sound Off
	121	BnH 79H 00H	O	X	Reset All Controller
	123	BnH 7BH 00H	O	X	All Notes Off
	126	BnH 7EH 00H	O	X	Mono On
	127	BnH 7FH 00H	O	X	Poly On
Program	Change	CnH PP	O	O	Sounds/Drum Set List
System	Exclusive	General MIDI Reset	X	X	

O:Yes, X:No

# GM Voice & Drum Table

## GM Voice Table

GM #	VOICE	GM #	VOICE
001	Grand Piano 1	065	Soprano Saxophone
002	Grand Piano 2	066	Alto Saxophone
003	Grand Piano 3	067	Tenor Saxophone
004	Honky Tonk	068	Baritone Saxophone
005	Electric Piano 1	069	Oboe
006	Electric Piano 2	070	English Horn
007	Harpichord	071	Bassoon
008	Clavinet	072	Clarinet
009	Celesta	073	Piccolo
010	Glockenspiel	074	Flute
011	Music Box	075	Recorder
012	Vibraphone	076	Pan Flute
013	Marimba	077	Bottle Blow
014	Xylophone	078	Shakuhachi
015	Tubular Bell	079	Whistle
016	Dulcimer	080	Ocarina
017	Electric Organ 1	081	Square
018	Electric Organ 2	082	Sawtooth
019	Electric Organ 3	083	Calliope
020	Pipe Organ	084	Chiffer
021	Reed Organ	085	Charang
022	Accordion	086	Solo Vox
023	Harmonica	087	Fifths
024	Bandonion	088	Bass Lead
025	Nylon Guitar	089	Fantasia
026	Steel Guitar	090	Warm Pad
027	Jazz Guitar	091	Poly Synth
028	Clean Guitar	092	Space Vox
029	Muted Guitar	093	Bow Glass
030	Drive Guitar	094	Metal Pad
031	Lead Guitar	095	Halo Pad
032	Harmonic Guitar	096	Sweep Pad
033	Acoustic Bass	097	Ice Rain
034	Finger Bass	098	Sound Track
035	Pick Bass	099	Crystal
036	Fretless Bass	100	Atmosphere
037	Slap Bass 1	101	Brightness
038	Slap Bass 2	102	Goblin
039	Synth Bass 1	103	Echo Drop
040	Synth Bass 2	104	Star Theme
041	Violin	105	Sitar
042	Viola	106	Banjo
043	Cello	107	Shamisen
044	Contra Bass	108	Koto
045	Tremolo Strings	109	Kalimba
046	Pizzicato Strings	110	Bagpipe
047	Harp	111	Fiddle
048	Timpani	112	Shanai
049	Strings	113	Tinkle Bell
050	Slow Strings	114	Agogo
051	Synth Strings 1	115	Steel Drum
052	Synth Strings 2	116	Wood Block
053	Choir Aahs	117	Taiko
054	Voice Oohs	118	Melody Tom
055	Synth Voice	119	Synth Drum
056	Orchestra Hit	120	Reversed Cymbal
057	Trumpet	121	Guitar Noise
058	Trombone	122	Breath Noise
059	Tuba	123	Sea Shore
060	Muted Trumpet	124	Birds
061	French Horn	125	Telephone
062	Brass Section	126	Helicopter
063	Synth Brass 1	127	Applause
064	Synth Brass 2	128	Gunshot

## Drum Table

	Prog 1 (Standard Drum)
27 - D#1	High Q
28 - E1	Slap
29 - F1	Scratch Push
30 - F#1	Scratch Pull
31 - G1	Sticks
32 - G#1	Square Click
33 - A1	Metronome Click
34 - A#1	Metronome Bell
35 - B1	Kick drum2/Jazz BD2
36 - C1	Kick drum1/Jazz BD1
38 - D2	Snare Drum1
39 - D#2	Hand Clap
40 - E2	Snare Drum 2
41 - F2	Low Floor Tom
42 - F#2	Closed Hi Hat [EXC1]
43 - G2	High Floor Tom
44 - G#2	Pedal Hi-Hat [EXC1]
45 - A2	Low Tom
46 - A#2	Open Hi-Hat [EXC1]
47 - B2	Low-Mid Tom
48 - C2	Hi Mid Tom
49 - C#3	Crash Cymbal 1
50 - D3	High Tom
51 - D#3	Ride Cymbal 1
52 - E3	Chinese Cymbal
53 - F3	Ride Bell
54 - F#3	Tambourine
55 - G3	Splash Cymbal
56 - G#3	Cowbell
57 - A3	Crash Cymbal2
58 - A#3	Vibraslap
59 - B3	Ride Cymbal2
60 - C4	Hi Bongo
61 - C#4	Low Bongo
62 - D4	Mute Hi Conga
63 - D#4	Open Hi Conga
64 - E4	Low Conga
65 - F4	High Timbale
66 - F#4	Low Timbale
67 - G4	High Timbale
68 - G#4	Low Agogo
69 - A4	Cabasa
70 - A#4	Maracas
71 - B4	Short Whistle[EXC2]
72 - C5	Long Whistle[EXC2]
73 - C#5	Short Guiro[EXC3]
74 - D5	Long Guiro[EXC3]
75 - D#5	Claves
76 - E5	Hi Wood Block
77 - F5	Low Wood Block
78 - F#5	Mute Cuica[EXC4]
79 - G5	Open Cuica[EXC4]
80 - G#5	Mute Triangle[EXC5]
81 - A5	Open Triangle[EXC5]
82 - A#5	Shaker
83 - B5	Jingle Bell
84 - C6	Belltree
85 - C#6	Castanets
86 - D6	Mute Surdo[EXC6]
87 - D#6	Open Surdo[EXC6]
88 - E6	Orchestra Cymbal

# Troubleshooting

If a problem occurs while using the product, first check the points listed below prior to contacting customer service.

Problem	Cause	Solution
The piano does not turn on.	1) The power cord is not properly plugged. 2) The power switch is not pressed. (The button is lighted when it is pressed.)	1) Properly plug the power cord. 2) Press the power switch. 3) Contact customer service.
The speakers produce no sound when a key is played.	1) The master volume is set to minimum. 2) A headphone is connected. 3) The power connection jack of the power cord is not properly connected to the product. 4) The treble/bass volume is set to minimum.	1) Increase the master volume. 2) Disconnect the headphone. 3) Properly connect the power connection jack to the product. 4) Increase the part volumes.
There are notable difference between the volumes of the main voice and the secondary voice.	1) The secondary voice volume is set to a wrong value.	1) Set the secondary voice volume properly.
Random noise is heard when using the product.	1) Other electric products such as a refrigerator or an electric washer are operating nearby.	1) Use the product faraway from other electric products, particularly those that use motors.
No sound is heard when using the product connected to an external sound device.	1) The master volume is set to minimum. 2) The connecting cord is cut or damaged.	1) Increase the master volume. 2) Replace the cord.

# Product Specifications

<b>Product Name</b>	USB Stereo Digital Piano
<b>Keyboard</b>	88 fully weighted hammer keys - 7 1/4 octaves
<b>Touch</b>	Off, Hard, Normal, Soft
<b>Maximum Polyphony</b>	256
<b>Voices</b>	26(1 Drum set included), GM 128(via MIDI)
<b>Features</b>	LAYER SPLIT TWIN PIANO TRANSPOSE TUNE EXV REVERB
<b>DSP</b>	
<b>Demo</b>	Beyer, Czerny 100/30/40, Burgmüller etudes and other selected works by famous composers for a total of 396 pieces Part playing options included for all but the 50 selected works
<b>Metronome</b>	Yes (Tempo & beat adjustable)
<b>Recording</b>	Real-time recording 1 track 6,500 Maximum notes
<b>Pedals</b>	3 (Soft, Sostenuto, Sustain)
<b>Volume Control</b>	Main, Secondary
<b>Jacks</b>	AUX IN/OUT USB Input 2 Headphones Jacks
<b>Speakers</b>	5x3 inch x 2, 2 inch x 2
<b>Power</b>	15W + 15W
<b>Power Consumption</b>	AC Adapter
<b>Size (W x D x H)</b>	1,380 x 415 x 815 mm
<b>Weight</b>	43KG
<b>Accessories</b>	Manual, AC Adaptor



